

## ***CHRISTCHURCH BOYS HIGH SCHOOL MASTERPLAN***

**DRAFT**



# SITE ANALYSIS

Local context





# SITE ANALYSIS- GROUND CONDITIONS

Existing buildings

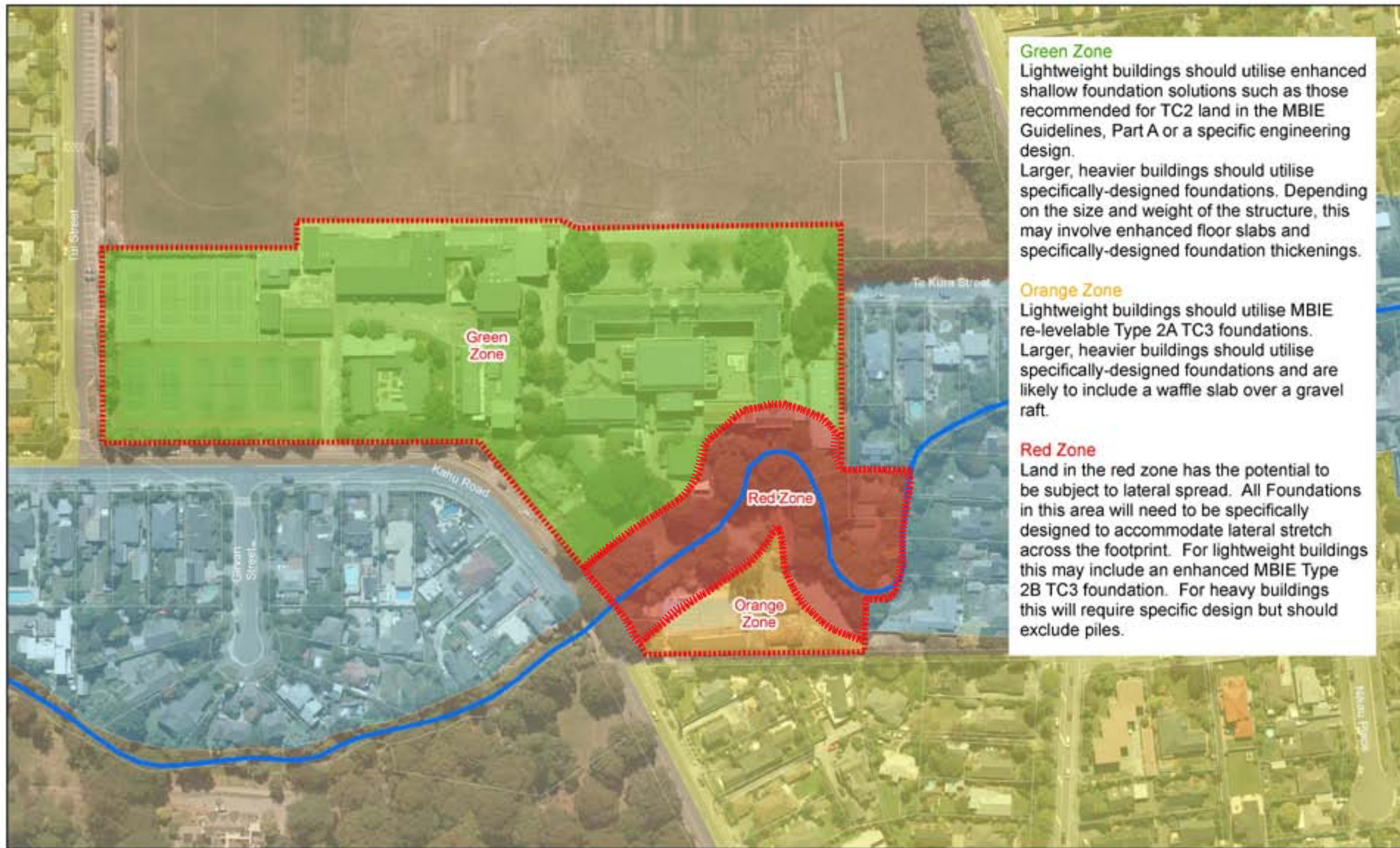

**Green Zone**  
 Lightweight buildings should utilise enhanced shallow foundation solutions such as those recommended for TC2 land in the MBIE Guidelines, Part A or a specific engineering design.  
 Larger, heavier buildings should utilise specifically-designed foundations. Depending on the size and weight of the structure, this may involve enhanced floor slabs and specifically-designed foundation thickenings.

**Orange Zone**  
 Lightweight buildings should utilise MBIE re-levelable Type 2A TC3 foundations. Larger, heavier buildings should utilise specifically-designed foundations and are likely to include a waffle slab over a gravel raft.

**Red Zone**  
 Land in the red zone has the potential to be subject to lateral spread. All Foundations in this area will need to be specifically designed to accommodate lateral stretch across the footprint. For lightweight buildings this may include an enhanced MBIE Type 2B TC3 foundation. For heavy buildings this will require specific design but should exclude piles.

<p>Paper Size A3 (Scale 1:1,500)</p>		<p><b>TC Zones</b></p> <ul style="list-style-type: none"> <li><span style="display: inline-block; width: 15px; height: 15px; background-color: yellow; border: 1px solid black; margin-right: 5px;"></span> TC2</li> <li><span style="display: inline-block; width: 15px; height: 15px; background-color: lightblue; border: 1px solid black; margin-right: 5px;"></span> TC3</li> </ul>	<p><b>Option Areas</b></p> <ul style="list-style-type: none"> <li><span style="display: inline-block; width: 15px; height: 15px; background-color: lightgreen; border: 1px solid black; margin-right: 5px;"></span> Green Zone</li> <li><span style="display: inline-block; width: 15px; height: 15px; background-color: orange; border: 1px solid black; margin-right: 5px;"></span> Orange Zone</li> <li><span style="display: inline-block; width: 15px; height: 15px; background-color: red; border: 1px solid black; margin-right: 5px;"></span> Red Zone</li> </ul>	<p><small>Important notice</small></p> <p>This map includes data extracted from the Canterbury Geotechnical Database (<a href="https://canterburygeotechnicaldatabase.projects98.com/">https://canterburygeotechnicaldatabase.projects98.com/</a>), which was prepared and/or compiled for the Earthquake Commission (EQC) to assist in assessing insurance claims made under the Earthquake Commission Act 1985.</p> <p>The source firms and data were not intended for any other purpose. EQC and its engineers, Tuckers &amp; Taylor, have no liability for any use of the maps and data or for the consequences of any person relying on them in any way. This "important notice" must be reproduced whenever this data or any derivatives are reproduced.</p>		<p>Ministry of Education          Christchurch Boys' High School</p>	<p>Job Number   51-32118          Revision   A          Date   16 Dec 2013</p>		
<p>Map Projection: Transverse Mercator          Horizontal Datum: NZGD 2000          Grid: NZGD 2000 New Zealand Transverse Mercator</p>		<p><span style="display: inline-block; width: 15px; height: 15px; background-color: blue; border: 1px solid black; margin-right: 5px;"></span> Avon River</p>		<p>GHD House, 226 Anzac Street, Christchurch 8011, PO Box 13468, Christchurch 8141 New Zealand T 64 3 378 0900 F 64 3 377 8575 E <a href="mailto:chomeal@ghd.co.nz">chomeal@ghd.co.nz</a> W <a href="http://www.ghd.com">www.ghd.com</a></p>				<p>Foundation Option Areas Appendix A</p>	

© 2013. Whilst every care has been taken to prepare this map, GHD make no representation or warranties about its accuracy, reliability, completeness or suitability for any particular purpose and cannot accept liability and responsibility of any kind (whether in contract, tort or otherwise) for any expenses, losses, damages and/or costs (including indirect or consequential damage) which are or may be incurred by any party as a result of the map being inaccurate, incomplete or unsuitable in any way and for any reason. Data source: EQC, Christchurch Aerial Imagery (2011), Reson (2012-13-04), MBIE sources (2012-12-04), CERA, TC Zone (20th Technical Classes (03/04) 2012-10-31 CERA Web Service on 2013-06-18), GHD, Foundation Option Areas. Created by GHD.

**DRAFT**



# SITE ANALYSIS

Existing property

 SCHOOL BOUNDARY

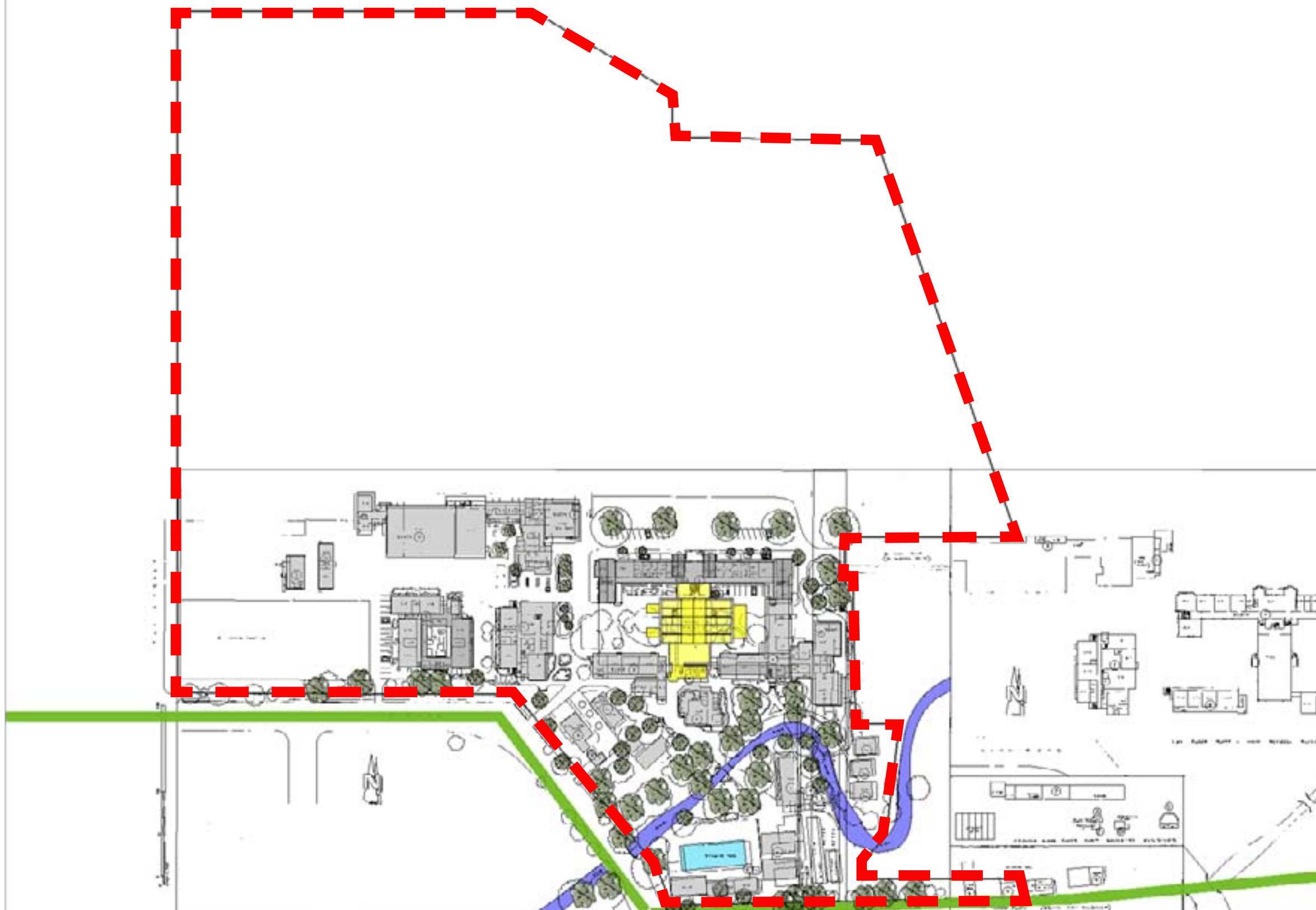

# SKETCH OPTION (LONG TERM)

Reinstate hall and library



<span style="display:inline-block; width:15px; height:15px; background-color:orange; border:1px solid black;"></span>	<b>OPTION FOR REFURBISHMENT</b>	
	HALL AND LIBRARY (BLOCK A5)	2,430m <sup>2</sup>
<b>POTENTIAL NEW BLOCKS (FLOOR PLATE) 2 STORIES</b>		
	NEW CADDICK	(730m <sup>2</sup> ) 1460m <sup>2</sup>
	NEW MAIN WING (SW)	(540m <sup>2</sup> ) 1080m <sup>2</sup>
	NEW CALDWELL	(640m <sup>2</sup> ) 1500m <sup>2</sup>
	NEW GYM	(1800m <sup>2</sup> ) 1900m <sup>2</sup>
	<b>SUBTOTAL:</b>	<b>approx. 7,420m<sup>2</sup></b>

**SPG ALLOWANCE 501 m<sup>2</sup>**  
 note: hall / library building is 3 levels. comparison of one floor plate only



# SKETCH OPTION (LONG TERM)

## West hall + gym

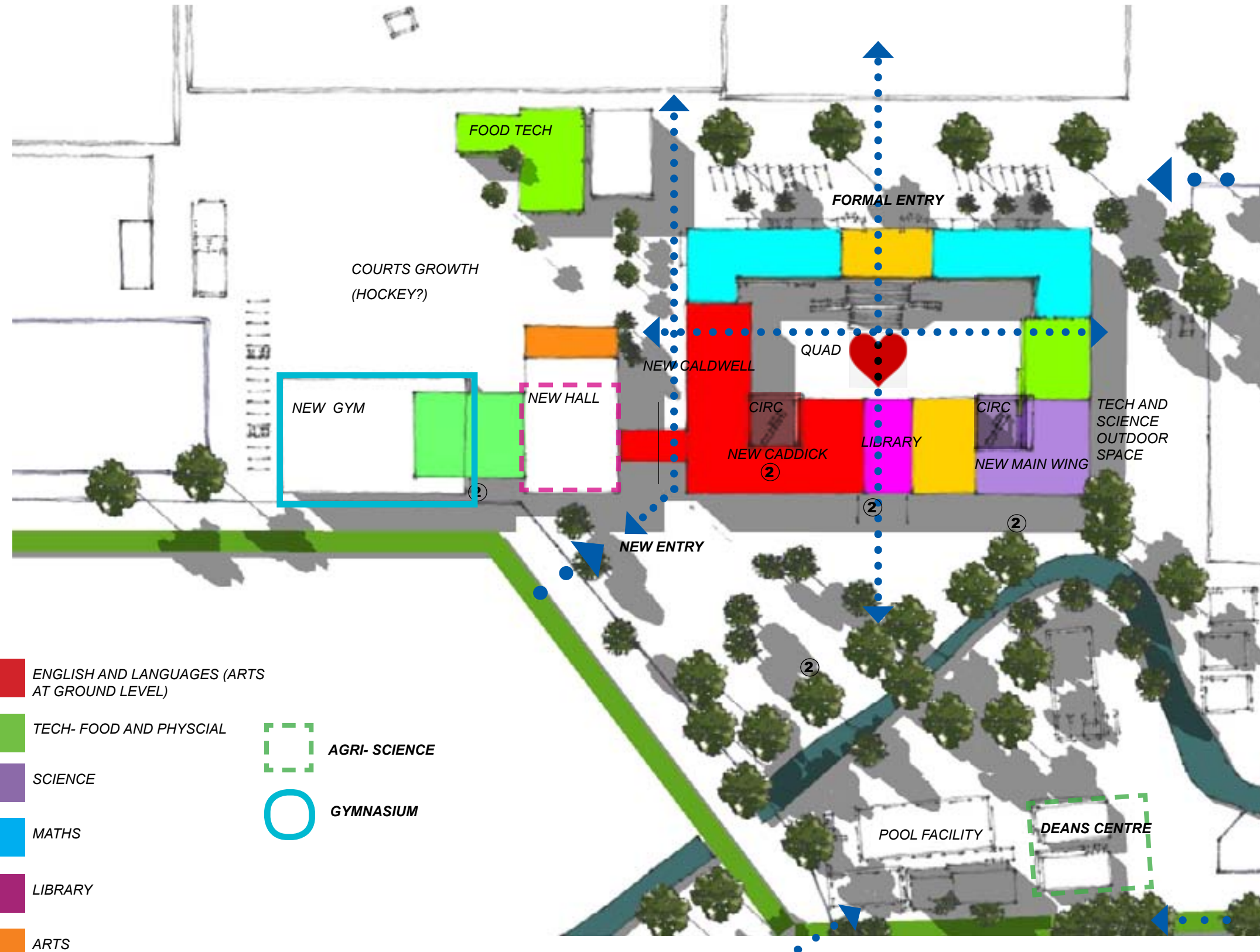

### POTENTIAL NEW BLOCKS (FLOOR PLATE) 2 STORIES









NEW CADDICK	(730m <sup>2</sup> )	1460m <sup>2</sup>
NEW MAIN WING (SW)	(540m <sup>2</sup> )	1080m <sup>2</sup>
NEW CALDWELL	(640m <sup>2</sup> )	1500m <sup>2</sup>
NEW HALL	(750m <sup>2</sup> )	1100m <sup>2</sup>
NEW GYM	(1800m <sup>2</sup> )	1900m <sup>2</sup>
LIBRARY	(250m <sup>2</sup> )	380m <sup>2</sup>

**SUBTOTAL:** approx. 7,420m<sup>2</sup>

**TOTAL AREA** approx. 11,050m<sup>2</sup>

**CURRENT ENTITLEMENT FOR 1314 STUDENTS** 11,206m<sup>2</sup>

 **SPG ALLOWANCE HALL 501 m<sup>2</sup>**  
note: proposed hall contain 2 level areas. comparison of one floor plate only

-  ENGLISH AND LANGUAGES (ARTS AT GROUND LEVEL)
-  TECH- FOOD AND PHYSICAL
-  SCIENCE
-  MATHS
-  LIBRARY
-  ARTS
-  ADMIN
-  AGRI- SCIENCE
-  GYMNASIUM

 PEDESTRIAN CONNECTIONS

# SKETCH OPTION (LONG TERM)

## Southern hall + West gym

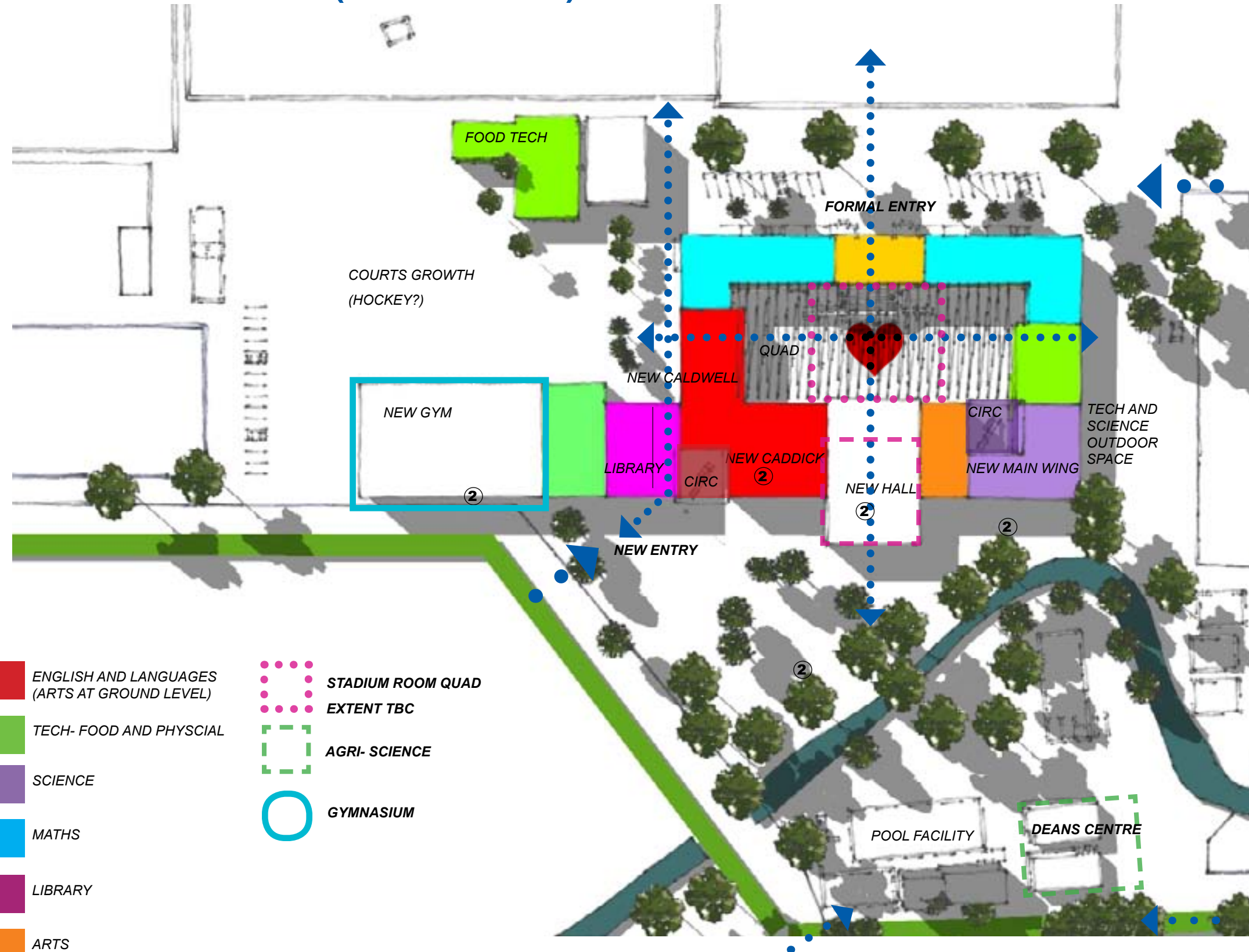

### POTENTIAL NEW BLOCKS (FLOOR PLATE) 2 STORIES











NEW CADDICK	(730m <sup>2</sup> )	1460m <sup>2</sup>
NEW MAIN WING (SW)	(540m <sup>2</sup> )	1080m <sup>2</sup>
NEW CALDWELL	(640m <sup>2</sup> )	1500m <sup>2</sup>
NEW HALL	(750m <sup>2</sup> )	1100m <sup>2</sup>
NEW GYM	(1800m <sup>2</sup> )	1900m <sup>2</sup>
LIBRARY	(250m <sup>2</sup> )	380m <sup>2</sup>

**SUBTOTAL:** approx. 7,420m<sup>2</sup>

**TOTAL AREA** approx. 11,050m<sup>2</sup>

**CURRENT ENTITLEMENT FOR 1314 STUDENTS** 11,206m<sup>2</sup>

 **SPG ALLOWANCE HALL 501 m<sup>2</sup>**  
note: proposed hall contain 2 level areas. comparison of one floor plate only

-  ENGLISH AND LANGUAGES (ARTS AT GROUND LEVEL)
-  TECH- FOOD AND PHYSICAL
-  SCIENCE
-  MATHS
-  LIBRARY
-  ARTS
-  ADMIN
-  STADIUM ROOM QUAD  
EXTENT TBC
-  AGRI- SCIENCE
-  GYMNASIUM

 PEDESTRIAN CONNECTIONS